

IMPROVEMENT PLANS FOR GUADALUPE JR. HIGH SCHOOL SIDEWALK PROJECT CITY OF GUADALUPE COUNTY OF SANTA BARBARA, STATE OF CALIFORNIA

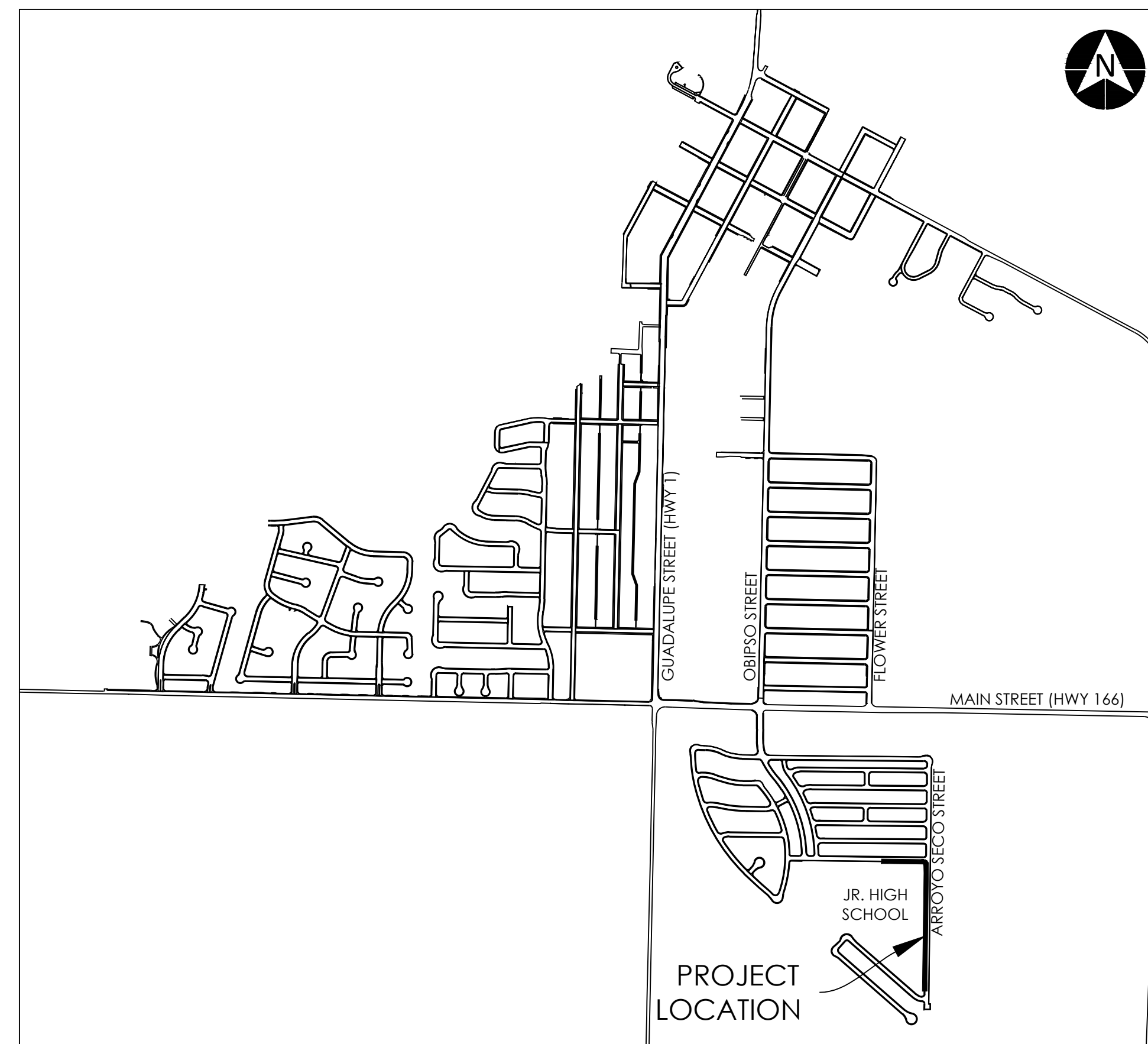

GENERAL NOTES

1. CONTRACTOR IS RESPONSIBLE FOR REPLACING ALL STRIPING WITHIN LIMITS OF WORK. STRIPING IS TO MATCH EXISTING UNLESS OTHERWISE SHOWN ON PLAN OR DIRECTED BY THE ENGINEER. ALL STRIPING SHALL BE THERMOPLASTIC.
2. THE CONTRACTOR IS RESPONSIBLE FOR OBTAINING ALL NECESSARY PERMITS TO COMPLETE WORK.
3. FOR DIGOUT AREAS OR AREAS TO BE REMOVED & REPLACED, THE CONTRACTOR SHALL ONLY REMOVE WHAT CAN BE REPLACED DURING THE SAME DAY. LOCATION OF DIGOUT AREAS OR AREAS TO BE REMOVED & REPLACED SHALL BE APPROVED BY THE ENGINEER.
4. TRAFFIC CONTROL DURING CONSTRUCTION SHALL BE THE CONTRACTOR'S RESPONSIBILITY. ALL TRAFFIC CONTROL AND DEVICES SHALL BE IN ACCORDANCE WITH THE LATEST EDITION OF THE "MANUAL OF UNIFORM TRAFFIC CONTROL DEVICES" ISSUE BY THE STATE OF CALIFORNIA DEPARTMENT OF TRANSPORTATION. LANE CLOSURES SHALL CONFORM TO STATE STANDARD PLANS AND SHALL BE APPROVED BY THE CITY.
5. THE CONTRACTOR SHALL BE RESPONSIBLE FOR ANY DAMAGE TO THE SITE OR THE SURROUNDING AREA, AS A RESULT OF THE CONTRACTOR'S WORK OR OPERATIONS. EXISTING FACILITIES THAT ARE DAMAGED OR DISPLACED BY THE CONTRACTOR SHALL BE REPLACED AT THE CONTRACTOR'S EXPENSE.
6. CONTRACTOR SHALL ENSURE POSITIVE DRAINAGE TO THE PROPOSED AND EXISTING DRAINAGE FACILITIES FROM EXISTING AND NEW PAVEMENT.
7. CONTRACTOR SHALL USE CALTRANS STRIPING DETAILS FOR ALL PAVEMENT MARKERS, TRAFFIC LINES, DETAILS AND LEGENDS.



Sheet List	
Sheet Number	Sheet Title
C1.0	TITLE
C2.0	SIDEWALK PLAN
C3.0	CURB RAMP AND DETAILS



4875 EL CAMINO REAL
ATASCADERO, CA 93422
805.470.1910 FAX 805.461.3175
WWW.EIKHOFDESIGNGROUP.COM

REVISIONS:									
CITY OF GUADALUPE									
PROJECT TITLE: GUADALUPE JR. HIGH SCHOOL SIDEWALK PROJECT					SHEET TITLE: TITLE				
DATE: 11/19/2025									
DRAWN BY: BJO									
CHECKED BY: JAV									
FILE NO. / LOCATION: #####									
SCALE: AS SHOWN									
SHEET NO. C1.0									
TOTAL NUMBER OF SHTS: 4									

PLOTTED: 11/19/2025 FILENAME: G:\GUADALUPE_PROJECTS\2024\School Sidewalk Project\DRAWINGS\Guadalupe Junior High School Sidewalk.dwg

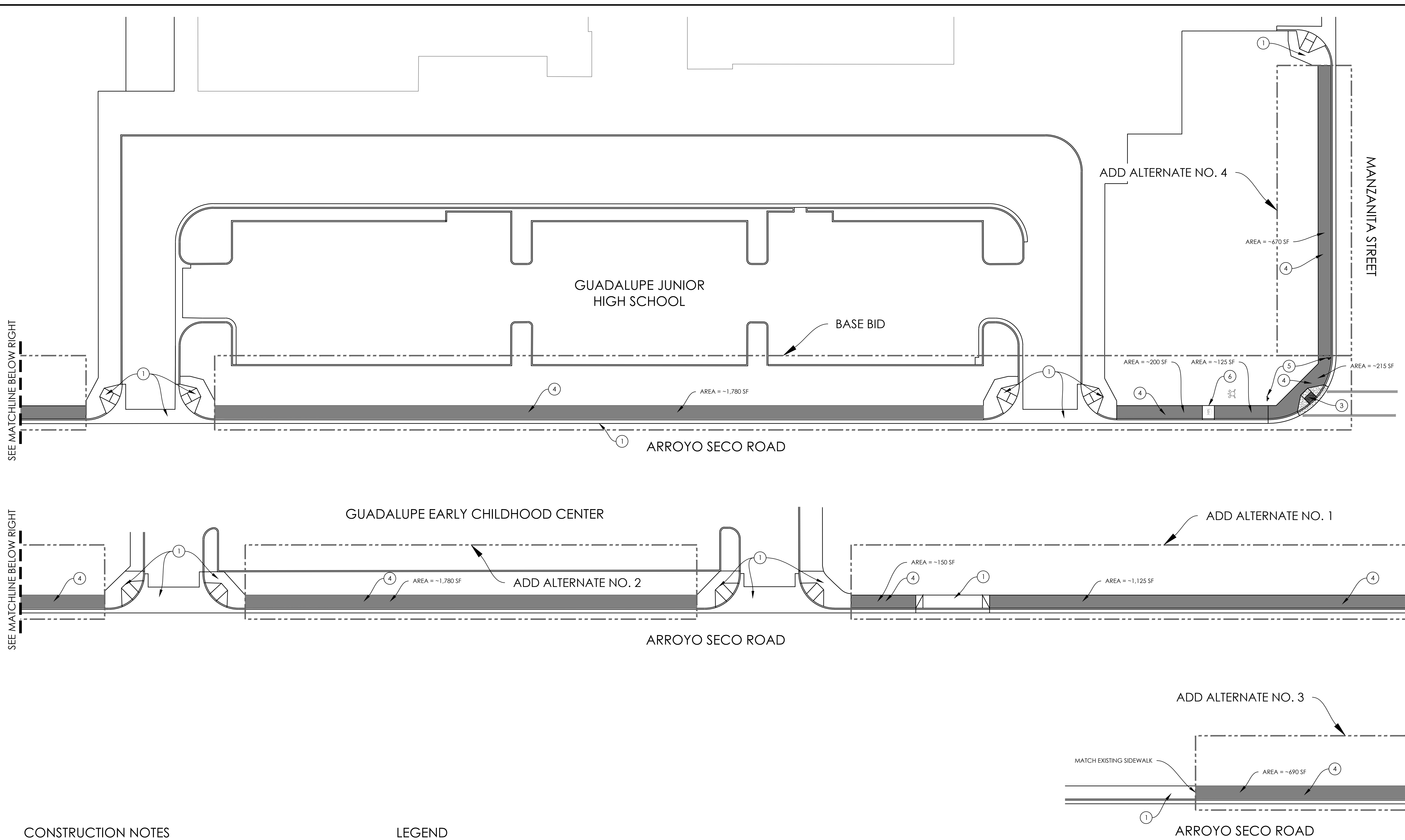

CONSTRUCTION NOTES

- ① PROTECT EXISTING FACILITIES
- ② INSTALL TRUNCATED DOMES PER CALTRANS STANDARD PLAN A88A
- ③ CONSTRUCT CURB RAMP PER DETAIL ON SHEET C3.0
- ④ CONSTRUCT SIDEWALK PER SANTA MARIA CITY STANDARD DRAWING RD-11.
- ⑤ EXISTING SIGN TO BE PROTECTED IN PLACE
- ⑥ EXISTING DRAINAGE INLET TO BE PROTECTED IN PLACE

LEGEND

- NEW CONCRETE FLATWORK (4" THICK MIN.)
- FL FLOWLINE
- TC TOP FACE OF CURB
- EDGE OF EXISTING ASPHALT
- FIRE HYDRANT
- MANHOLE
- SIGN POLE

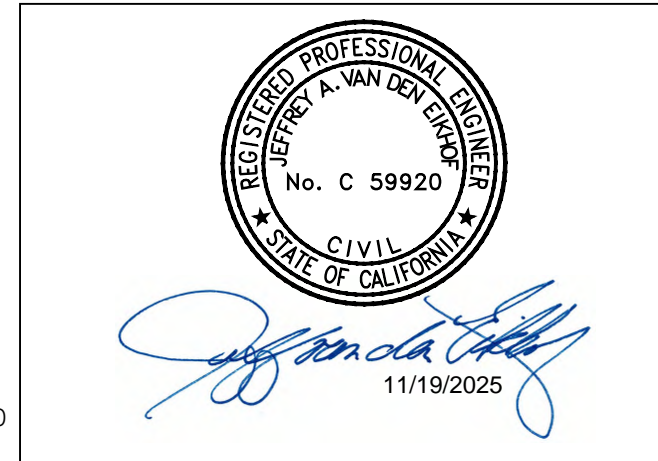
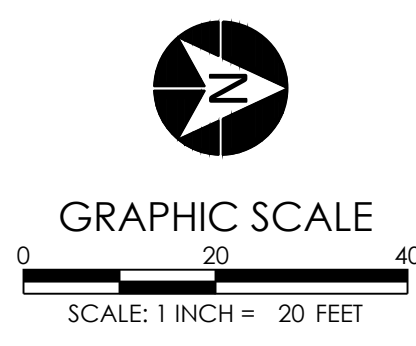

EIKHOF DESIGN GROUP

4875 EL CAMINO REAL
 ATASCADERO, CA 93422
 805.470.1910 FAX 805.461.3175
 WWW.EIKHOFDESIGNGROUP.COM

 CITY OF GUADALUPE	PROJECT TITLE: GUADALUPE JR. HIGH SCHOOL SIDEWALK PROJECT SHEET TITLE: SIDEWALK PLAN
PROJECT TITLE: GUADALUPE JR. HIGH SCHOOL SIDEWALK PROJECT	
SHEET TITLE: SIDEWALK PLAN	
DATE:	11/19/2025
DRAWN BY:	BJO
CHECKED BY:	JAV
FILE NO. / LOCATION:	###
SCALE:	AS SHOWN
SHEET NO.:	C2.0
TOTAL NUMBER OF SHTS: 4	

